

The regatta course

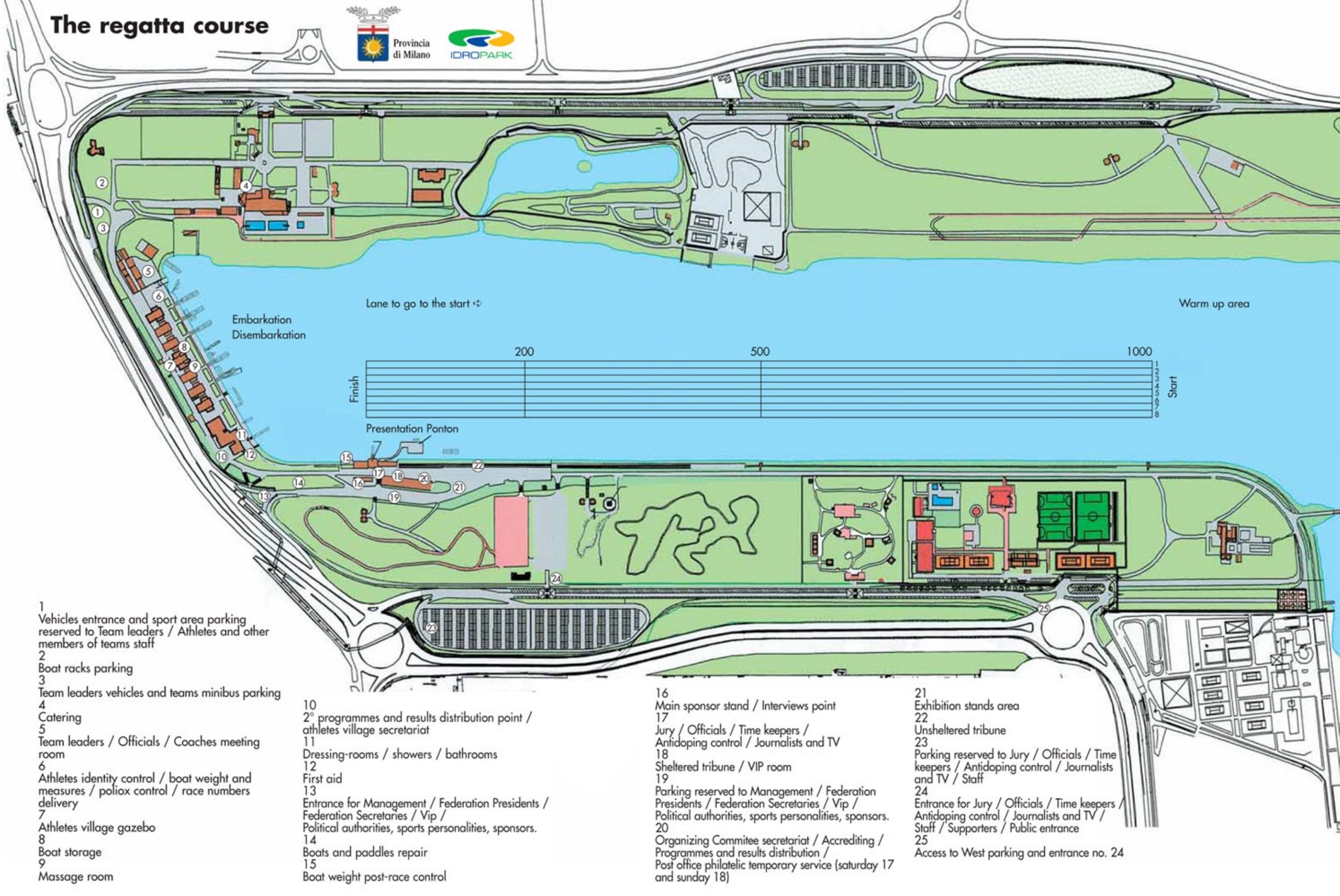

- 1 Vehicles entrance and sport area parking reserved to Team leaders / Athletes and other members of teams staff
- 2 Boat racks parking
- 3 Team leaders vehicles and teams minibus parking
- 4 Catering
- 5 Team leaders / Officials / Coaches meeting room
- 6 Athletes identity control / boat weight and measures / poliox control / race numbers delivery
- 7 Athletes village gazebo
- 8 Boat storage
- 9 Massage room

- 10 2° programmes and results distribution point / athletes village secretariat
- 11 Dressing-rooms / showers / bathrooms
- 12 First aid
- 13 Entrance for Management / Federation Presidents / Federation Secretaries / Vip / Political authorities, sports personalities, sponsors.
- 14 Boats and paddles repair
- 15 Boat weight post-race control

- 16 Main sponsor stand / Interviews point
- 17 Jury / Officials / Time keepers / Antidoping control / Journalists and TV
- 18 Sheltered tribune / VIP room
- 19 Parking reserved to Management / Federation Presidents / Federation Secretaries / Vip / Political authorities, sports personalities, sponsors.
- 20 Organizing Committee secretariat / Accrediting / Programmes and results distribution / Post office philatelic temporary service (saturday 17 and sunday 18)

- 21 Exhibition stands area
- 22 Unsheltered tribune
- 23 Parking reserved to Jury / Officials / Time keepers / Antidoping control / Journalists and TV / Staff
- 24 Entrance for Jury / Officials / Time keepers / Antidoping control / Journalists and TV / Staff / Supporters / Public entrance
- 25 Access to West parking and entrance no. 24